

PRIMROSE

THREE BEDROOM SEMI-DETACHED HOUSE
PLOTS 14, 15*, 16, 17*, 18, 19* & 20

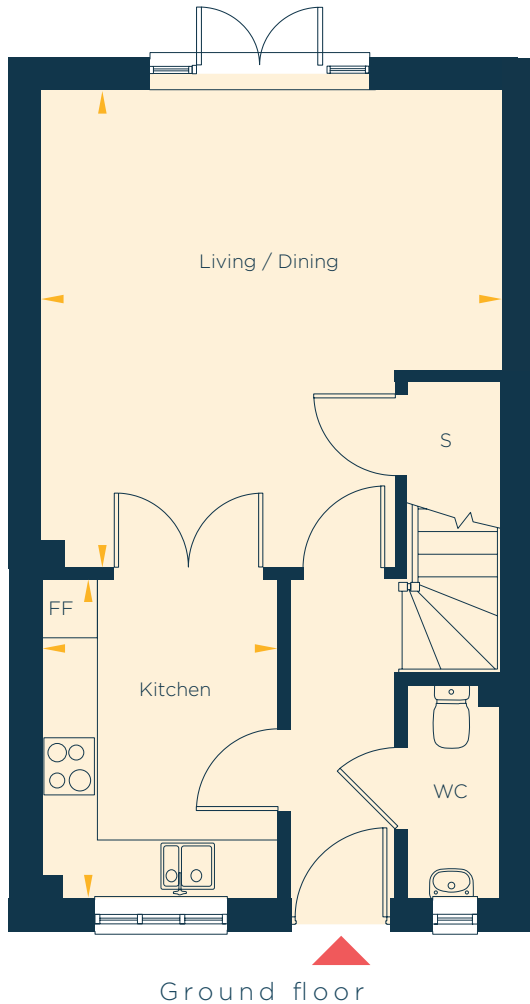

Ground floor

*Mirrored version of plan shown.

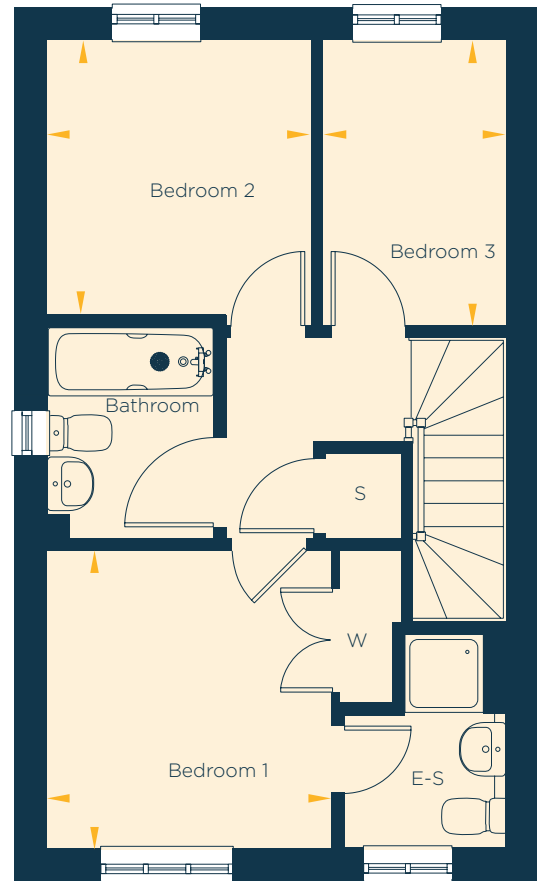

First floor

Total:	81.0 Sq M		872 Sq Ft	
Kitchen	2.47m	× 3.32m	8'1"	× 10'10"
Living/Dining	4.77m	× 4.94m	15'7"	× 16'2"
Bedroom 1	2.96m	× 3.09m	9'8"	× 10'1"
Bedroom 2	2.75m	× 2.86m	9'0"	× 9'4"
Bedroom 3	1.93m	× 2.97m	6'4"	× 9'9"

We wish to inform prospective buyers that we have prepared these floor plans for illustrative purposes; they should be used as a guide. All room sizes are approximate with dimensions of finished measurements. All room layouts are indicative and are subject to change. Dimensions should not be relied upon for carpet sizes, appliance sizes or items of furniture. Whilst every attempt has been made to ensure the accuracy of these floor plans, the information contained herein is a preliminary guide only and Myriad Homes take no responsibility for error, omission or misstatement. Myriad Homes reserve the right to make changes to these plans prior to exchange of contracts. Please speak to the Myriad Homes Sales Representative for further information.